

HOW SHOULD I USE THE BREZTRI[®] AEROSPHERE[®] INHALER?

Scan the QR code to watch a step-by-step video on how to use your BREZTRI AEROSPHERE inhaler.



Your BREZTRI AEROSPHERE is supplied as an inhaler that consists of a **pressurized canister** that fits into a plastic piece called an **actuator**—at one end of this is the **mouthpiece**, which is protected by an attached cover. On top of the canister, you will also see the **puff indicator**.

Reading the puff indicator

The puff indicator counts down by 1 each time you spray a puff of medicine. See below to learn more about the functional components of your puff indicator.

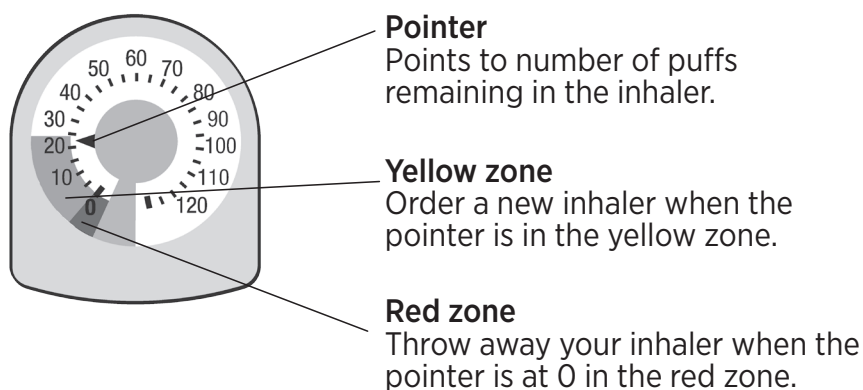

The display window for the 30-day inhaler shows 120 and the 14-day inhaler shows 60.

Do not try to take a puff when the pointer is at 0 because you will not receive a full dose.



BREZTRI[®]
AEROSPHERE[®]
budesonide / glycopyrronium / formoterol
fumarate dihydrate pressurized inhalation
suspension

Priming your inhaler

Priming ensures that you will receive the right amount of medicine when you use your inhaler. Before you use your inhaler for the first time, prime it by following the steps below.

1. Remove the mouthpiece cover by squeezing both sides and pulling out.

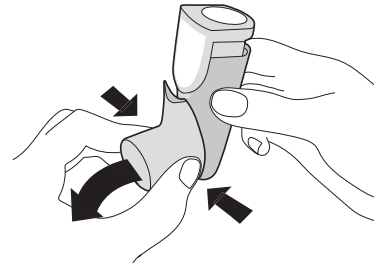

2. Shake the inhaler well and spray **1 test-puff** into the air facing away from you. Repeat this step a total of 4 times, shaking before each test-puff.

x4 total shakes and test-puffs

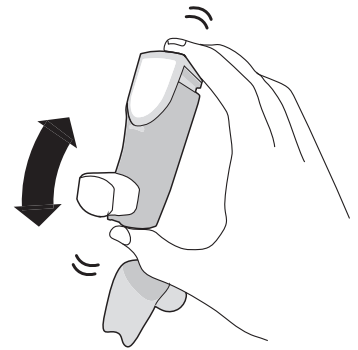

Re-prime your inhaler:

- After rinsing the actuator
- If dropped
- If not used for more than 7 days

To re-prime, spray **2 test-puffs**, shaking before each test-puff.

x2 total shakes and test-puffs

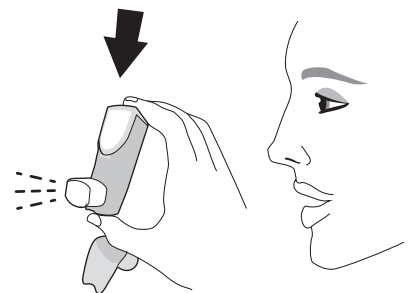

Extra puffs are provided for priming.
Do not skip priming.

Using your inhaler daily

Follow the instructions below to inhale your medicine. Take **2 puffs in the morning** and **2 puffs in the evening**.

1. Remove the mouthpiece cover.
Check the mouthpiece for foreign objects and remove objects before use.

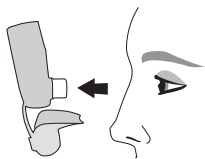

3. Repeat Step 2 for a second puff.



2. Shake the inhaler well before each puff.

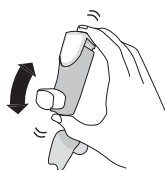

Breathe out fully.

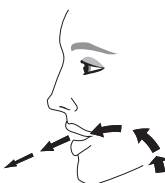

Place the mouthpiece into your mouth and close your lips around it.



Start to breathe in deeply and slowly while spraying **1 puff**. Continue breathing in until you cannot anymore.

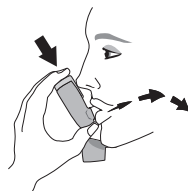

Hold your breath for as long as you can, up to **10 seconds**.

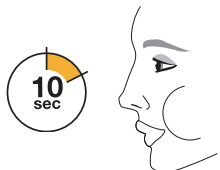

4. Put the mouthpiece cover back on.

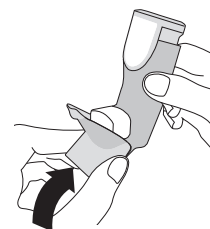

5. Rinse your mouth with water. Spit out the water and **do not swallow**.

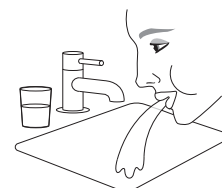

Remember to **rinse your mouth with water** after the 2 puffs to prevent fungal infection.

Weekly rinse

Rinse the yellow actuator weekly so that the medicine does not build up and block the spray through the mouthpiece. It's a good idea to mark this day in your calendar or add a reminder on your phone.

- Rinse the yellow actuator weekly.
- Do not allow the canister to get wet.
- Re-prime after rinsing.

1. Remove the canister and set it aside. **Do not allow the canister to get wet.**

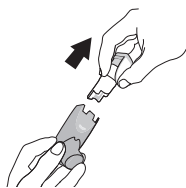

5. Look into the actuator and mouthpiece for medicine build-up. If there is any build-up, repeat Steps 3 through 5.

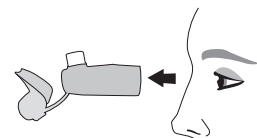

2. Remove the mouthpiece cover.

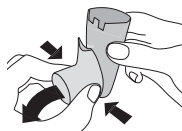

6. Air-dry, preferably overnight. **Do not** put the canister back into the actuator if it is still wet.

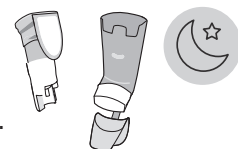

3. Run warm water through the mouthpiece for 30 seconds and then through the top of the actuator for 30 seconds. **Rinse for 60 seconds in total.**



7. When dry, **replace the mouthpiece cover first** and then gently press the canister down into the actuator.

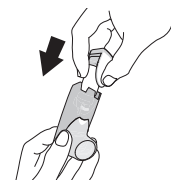

4. Shake off as much water as you can. **Do not** dry with a towel or tissue.



8. Re-prime the inhaler by spraying **2 test-puffs**, shaking before each test-puff.

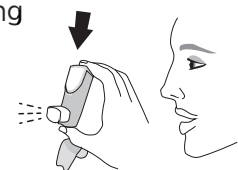

x2 total shakes and test-puffs

Other important information

Important reminders



- For oral inhalation use only
- Prime your BREZTRI AEROSPHERE inhaler before using it for the first time
- Rinse your yellow actuator weekly
- Take 2 puffs of medicine in the morning and 2 puffs of medicine in the evening
- Do not reuse or use the actuator with medicine canisters from other inhalers
- Do not puncture or throw the canister into a fire or incinerator

Storing your inhaler



- Store your inhaler at room temperature between 15°C and 30°C, in a dry place
- **Do not store in a humid environment, such as a bathroom**
- Keep your inhaler and all medicines out of the reach and sight of children

Disposing of your inhaler



- Dispose of your inhaler after the last dose, following local guidelines
- If you are unsure of how to dispose of it, ask your pharmacist and they can tell you what to do with medicines you no longer need
- Help protect the environment by disposing of your medications properly

BREZTRI®, AEROSPHERE®, and the AstraZeneca logo are registered trademarks of AstraZeneca AB, all used under license by AstraZeneca Canada Inc.

© AstraZeneca Canada Inc. 2024
1004 Middlegate Road, Suite 5000, Mississauga, Ontario, L4Y 1M4

